



Norwood High Street, SE27 | £465,000

02087029888

westnorwood@pedderproperty.com

pedder
We live local



In General

- Two double bedrooms
- Chain free
- Light & bright
- Great transport links
- Courtyard garden

In Detail

This well-presented two-bedroom split-level apartment is ideally located on Norwood High Street, SE27, offering convenient access to local amenities and transport links.

The property benefits from over 770 sq. ft. of internal living space, creating a bright and well-balanced home.

Upon entering, you are welcomed into a generously sized open-plan kitchen and reception area. This space is perfect for both relaxing and entertaining, featuring a fully fitted kitchen, ample room for dining, and a large window that floods the room with natural light, enhancing the sense of space throughout.

The lower level of the apartment comprises two spacious double bedrooms, both thoughtfully laid out. The primary bedroom benefits from a contemporary en-suite shower room and direct access to a private courtyard garden. A modern family bathroom serves the second bedroom.

Positioned just 0.1 miles from West Norwood station, the property offers excellent transport links with regular Thameslink and Southern services to London Bridge (approx. 23 mins), London Victoria (approx. 22 mins), and Blackfriars (approx. 26 mins).

There are several bus routes running along Norwood High Street, connecting you easily to nearby Brixton, Crystal Palace, Streatham, and Dulwich.

The location benefits from a fantastic sense of community, with a growing number of independent cafés, restaurants, shops, and the popular West Norwood Picturehouse cinema all within easy reach. The weekly West Norwood Feast market is a local favourite, offering artisan food, crafts, and vintage goods. Green spaces such as Norwood Park and Brockwell Park are also close by for weekend strolls or summer picnics.

EPC: C | Council Tax Band: C | Lease: 250 years remaining | SC: TBC | GR: peppercorn | BI: £350 pa



Floorplan

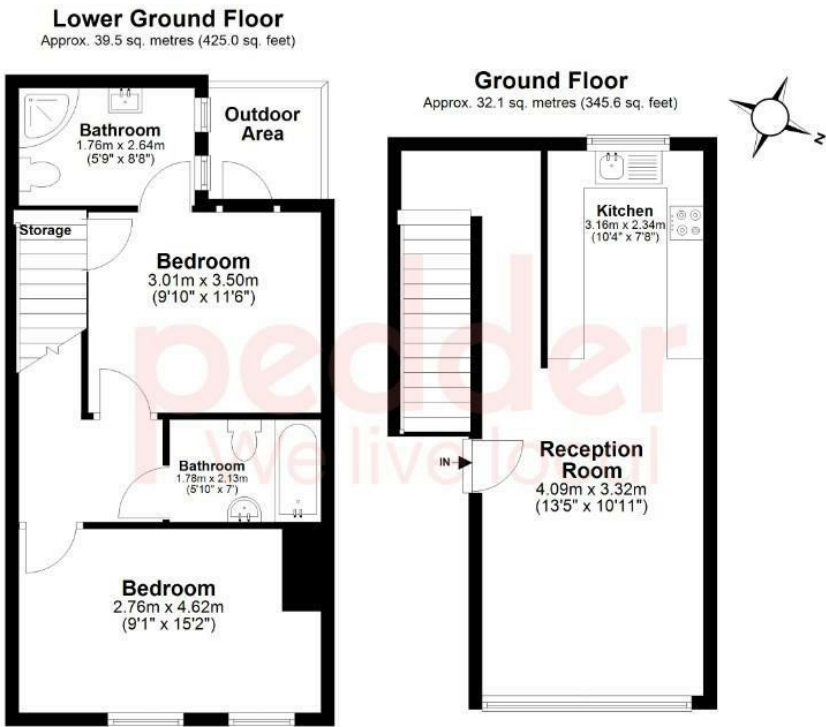

Total area: approx. 71.6 sq. metres (770.6 sq. feet)

Copyright www.pedderproperty.com 2024. These plans are for representation purposes only as Defined by RICS - Code of Measuring Practice. Not drawn to scale. windows and door measurements are approximate. please check dimensions, shapes and compass bearings before making any decisions reliant upon them.

Plan produced using PlanUp.

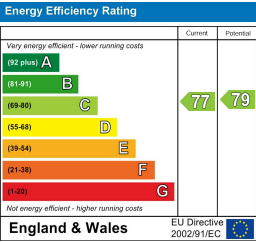

Pedder Property Ltd trading as Pedder for themselves and for the vendor/landlord of this property whose agents they are, give notice that (1) these particulars do not constitute any part of an offer or contract, (2) all statements contained within these particulars are made without responsibility on the part of Pedder or the vendor/landlord, (3) whilst made in good faith, none of the statements contained within these particulars are to be relied upon as a statement of representation or fact, (4) any intending purchaser/tenant must satisfy him/herself by inspection or otherwise as to the correctness of each of the statements contained within these particulars, (5) the vendor/landlord does not make or give either Pedder or any person in their employment any authority to make or give representation or warranty whatsoever in relation to this property.